

惠州市博罗县2026年度第六十四批次城镇建设用地红线图

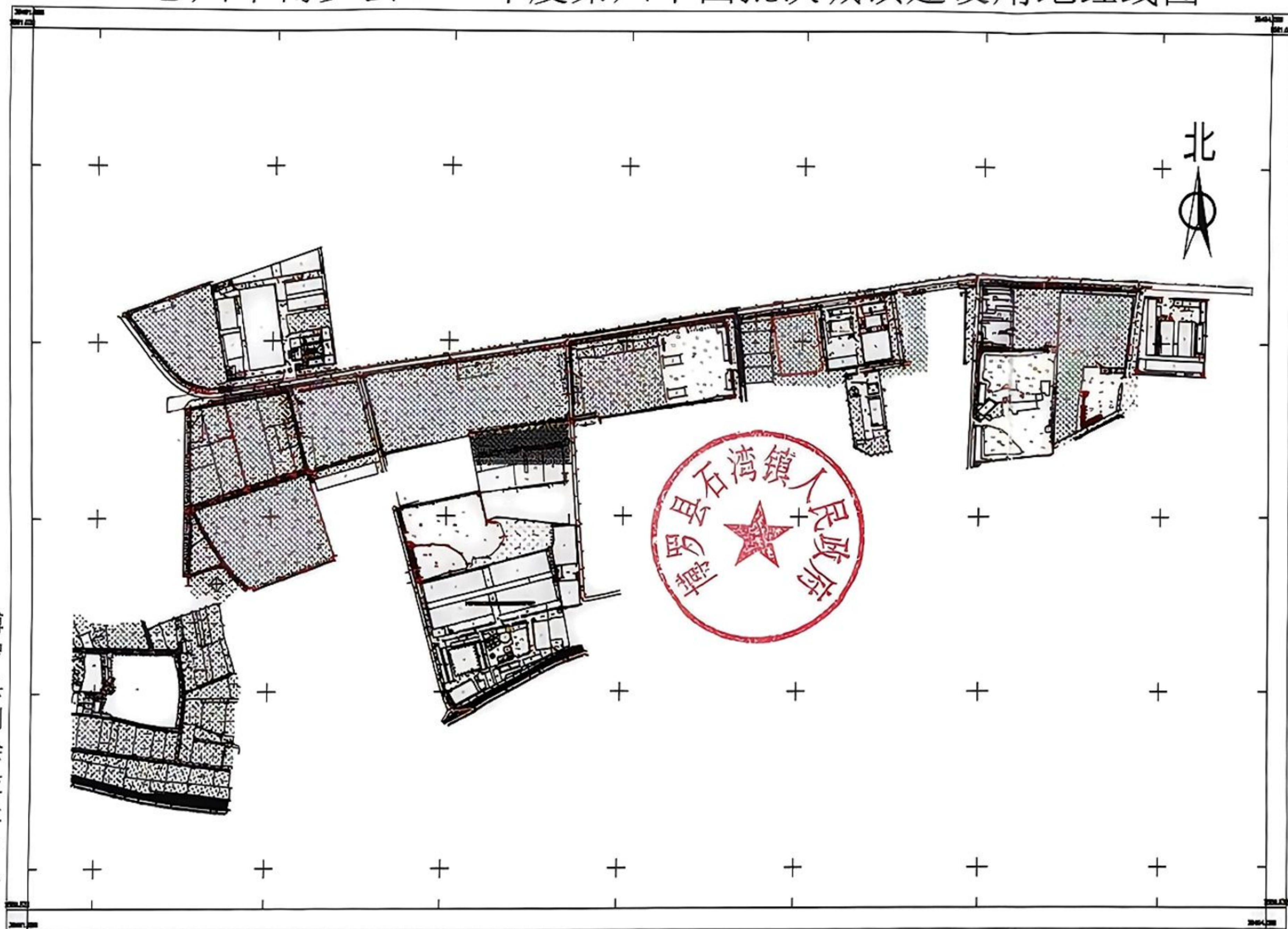

博罗县测绘技术中心
Autodesk 教育版产品制作

2025年12月数字化测图。面积：26541平方米。
 2000国家大地坐标系，1985国家高程基准。
 此图单独使用时，不作为权属依据。
 2017年版图式。

绘图员：杨书哲
 检查员：徐惠标、陈兴武

界址点坐标表			界址点坐标表			界址点坐标表			界址点坐标表		
点号	X	Y	点号	X	Y	点号	X	Y	点号	X	Y
1	256025.120	384331.660	35	256026.770	384302.070	110	256010.001	384328.877	164	256077.132	384328.265
2	256025.195	384330.307	36	256027.114	384301.138	111	256027.749	384327.701	165	256043.877	384377.705
3	256025.691	384332.511	37	256027.852	384307.673	112	256027.538	384327.535	166	256048.145	384374.233
4	256025.601	384332.490	38	256028.538	384303.225	113	256027.218	384327.480	167	256048.346	384377.107
5	256025.674	384332.978	39	256029.224	384303.775	114	256027.870	384328.811	168	256049.445	384377.170
6	256025.734	384333.447	40	256029.910	384303.874	115	256028.027	384328.546	169	256049.780	384325.229
7	256025.797	384333.852	41	256030.600	384304.110	116	256028.077	384328.125	170	256048.745	384328.114
8	256025.860	384334.207	42	256031.290	384304.300	117	256028.173	384328.587	171	256048.071	384328.085
9	256025.923	384334.512	43	256031.980	384304.540	118	256028.270	384328.516	172	256048.070	384328.329
10	256025.986	384334.767	44	256032.670	384304.830	119	256028.367	384328.241	173	256048.100	384328.105
11	256026.049	384335.072	45	256033.360	384305.170	120	256028.464	384327.966	174	256048.175	384328.070
12	256026.112	384335.327	46	256034.050	384305.560	121	256028.561	384327.691	175	256048.250	384328.035
13	256026.175	384335.582	47	256034.740	384305.950	122	256028.658	384327.416	176	256048.325	384328.000
14	256026.238	384335.837	48	256035.430	384306.340	123	256028.755	384327.141	177	256048.400	384327.965
15	256026.301	384336.092	49	256036.120	384306.730	124	256028.852	384326.866	178	256048.475	384327.930
16	256026.364	384336.347	50	256036.810	384307.120	125	256028.949	384326.591	179	256048.550	384327.895
17	256026.427	384336.602	51	256037.500	384307.510	126	256029.046	384326.316	180	256048.625	384327.860
18	256026.490	384336.857	52	256038.190	384307.900	127	256029.143	384326.041	181	256048.700	384327.825
19	256026.553	384337.112	53	256038.880	384308.290	128	256029.240	384325.766	182	256048.775	384327.790
20	256026.616	384337.367	54	256039.570	384308.680	129	256029.337	384325.491	183	256048.850	384327.755
21	256026.679	384337.622	55	256040.260	384309.070	130	256029.434	384325.216	184	256048.925	384327.720
22	256026.742	384337.877	56	256040.950	384309.460	131	256029.531	384324.941	185	256049.000	384327.685
23	256026.805	384338.132	57	256041.640	384309.850	132	256029.628	384324.666	186	256049.075	384327.650
24	256026.868	384338.387	58	256042.330	384310.240	133	256029.725	384324.391	187	256049.150	384327.615
25	256026.931	384338.642	59	256043.020	384310.630	134	256029.822	384324.116	188	256049.225	384327.580
26	256026.994	384338.897	60	256043.710	384311.020	135	256029.919	384323.841	189	256049.300	384327.545
27	256027.057	384339.152	61	256044.400	384311.410	136	256030.016	384323.566	190	256049.375	384327.510
28	256027.120	384339.407	62	256045.090	384311.800	137	256030.113	384323.291	191	256049.450	384327.475
29	256027.183	384339.662	63	256045.780	384312.190	138	256030.210	384323.016	192	256049.525	384327.440
30	256027.246	384339.917	64	256046.470	384312.580	139	256030.307	384322.741	193	256049.600	384327.405
31	256027.309	384340.172	65	256047.160	384312.970	140	256030.404	384322.466	194	256049.675	384327.370
32	256027.372	384340.427	66	256047.850	384313.360	141	256030.501	384322.191	195	256049.750	384327.335
33	256027.435	384340.682	67	256048.540	384313.750	142	256030.598	384321.916	196	256049.825	384327.300
34	256027.498	384340.937	68	256049.230	384314.140	143	256030.695	384321.641	197	256049.900	384327.265
35	256027.561	384341.192	69	256049.920	384314.530	144	256030.792	384321.366	198	256049.975	384327.230
36	256027.624	384341.447	70	256050.610	384314.920	145	256030.889	384321.091	199	256050.050	384327.195
37	256027.687	384341.702	71	256051.300	384315.310	146	256030.986	384320.816	200	256050.125	384327.160
38	256027.750	384341.957	72	256051.990	384315.700	147	256031.083	384320.541	201	256050.200	384327.125
39	256027.813	384342.212	73	256052.680	384316.090	148	256031.180	384320.266	202	256050.275	384327.090
40	256027.876	384342.467	74	256053.370	384316.480	149	256031.277	384319.991	203	256050.350	384327.055
41	256027.939	384342.722	75	256054.060	384316.870	150	256031.374	384319.716	204	256050.425	384327.020
42	256028.002	384342.977	76	256054.750	384317.260	151	256031.471	384319.441	205	256050.500	384326.985
43	256028.065	384343.232	77	256055.440	384317.650	152	256031.568	384319.166	206	256050.575	384326.950
44	256028.128	384343.487	78	256056.130	384318.040	153	256031.665	384318.891	207	256050.650	384326.915
45	256028.191	384343.742	79	256056.820	384318.430	154	256031.762	384318.616	208	256050.725	384326.880
46	256028.254	384344.000	80	256057.510	384318.820	155	256031.859	384318.341	209	256050.800	384326.845
47	256028.317	384344.255	81	256058.200	384319.210	156	256031.956	384318.066	210	256050.875	384326.810
48	256028.380	384344.510	82	256058.890	384319.600	157	256032.053	384317.791	211	256050.950	384326.775
49	256028.443	384344.765	83	256059.580	384320.000	158	256032.150	384317.516	212	256051.025	384326.740
50	256028.506	384345.020	84	256060.270	384320.390	159	256032.247	384317.241	213	256051.100	384326.705
51	256028.569	384345.275	85	256060.960	384320.780	160	256032.344	384316.966	214	256051.175	384326.670
52	256028.632	384345.530	86	256061.650	384321.170	161	256032.441	384316.691	215	256051.250	384326.635
53	256028.695	384345.785	87	256062.340	384321.560	162	256032.538	384316.416	216	256051.325	384326.600
54	256028.758	384346.040	88	256063.030	384321.950	163	256032.635	384316.141	217	256051.400	384326.565
55	256028.821	384346.295	89	256063.720	384322.340	164	256032.732	384315.866	218	256051.475	384326.530
56	256028.884	384346.550	90	256064.410	384322.730	165	256032.829	384315.591	219	256051.550	384326.495
57	256028.947	384346.805	91	256065.100	384323.120	166	256032.926	384315.316	220	256051.625	384326.460
58	256029.010	384347.060	92	256065.790	384323.510	167	256033.023	384315.041	221	256051.700	384326.425
59	256029.073	384347.315	93	256066.480	384323.900	168	256033.120	384314.766	222	256051.775	384326.390
60	256029.136	384347.570	94	256067.170	384324.290	169	256033.217	384314.491	223	256051.850	384326.355
61	256029.199	384347.825	95	256067.860	384324.680	170	256033.314	384314.216	224	256051.925	384326.320
62	256029.262	384348.080	96	256068.550	384325.070	171	256033.411	384313.941	225	256052.000	384326.285
63	256029.325	384348.335	97	256069.240	384325.460	172	256033.508	384313.666	226	256052.075	384326.250
64	256029.388	384348.590	98	256069.930	384325.850	173	256033.605	384313.391	227	256052.150	384326.215
65	256029.451	384348.845	99	256070.620	384326.240	174	256033.702	384313.116	228	256052.225	384326.180
66	256029.514	384349.100	100	256071.310	384326.630	175	256033.799	384312.841	229	256052.300	384326.145
67	256029.577	384349.355	101	256072.000	384327.020	176	256033.896	384312.566	230	256052.375	384326.110
68	256029.640	384349.610	102	256072.690	384327.410	177	256033.993	384312.291	231	256052.450	384326.075
69	256029.703	384349.865	103	256073.380	384327.800	178	256034.090	384312.016	232	256052.525	384326.040
70	256029.766	384350.120	104	256074.070	384328.190	179	256034.187	384311.741	233	256052.600	384326.005
71	256029.829	384350.375	105	256074.760	384328.580	180	256034.284	384311.466	234	256052.675	384325.970
72	256029.892	384350.630	106	256075.450	384328.970	181	256034.381	384311.191	235	256052.750	384325.935
73	256029.955	384350.885	107	256076.140	384329.360	182	256034.478	384310.916	236	256052.825	384325.900
74	256029.018	384351.140	108	256076.830	384329.750	183	256034.575	384310.641	237	256052.900	384325.865
75	256029.081	384351.395	109	256077.520	384330.140	184	256034.672	384310.366	238	256052.975	384325.830
76	256029.144	384351.650	110	256078.210	384330.530	185	256034.769	384310.091	239	256053.050	